

# D26-XXX090/140

Door type: door panel width mm (X), max opening mm

D26-XXX090: 1000 mm, 893,5 mm

D26-XXX140: 1500 mm, 1393,5 mm

XXX= Height on posts



Total width of door (090)=2010 mm (max)= X+Y+110

Total width of door (140)=3010 mm (max)= X+Y+110

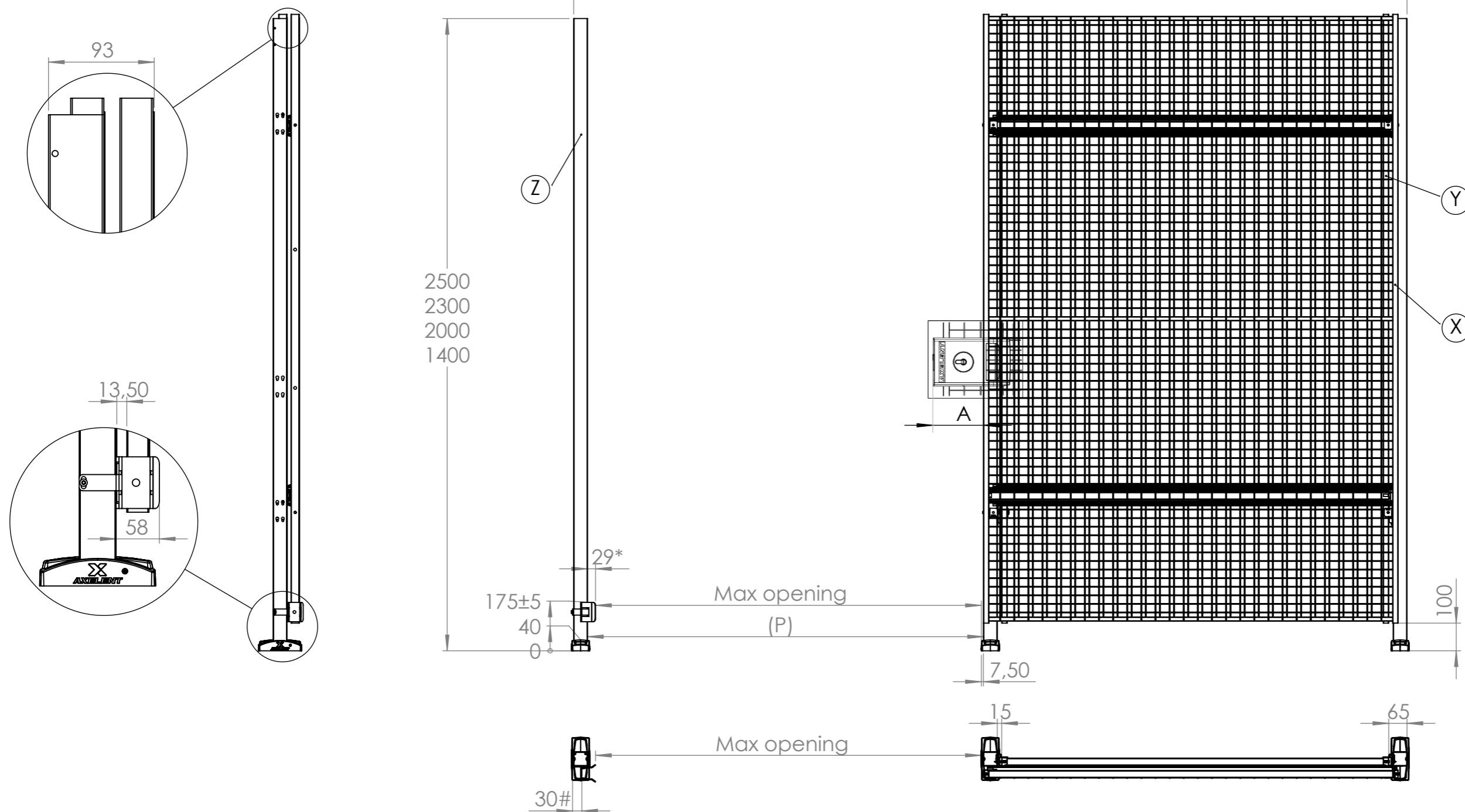

<b>Max opening = X (panel width) - 106,5 mm</b> (106,5 mm= (door accessories*) + 7,50 + 50 + 20 mm)
(P) Post to post opening = X (panel width) - 70 mm** (**= panel in closed position overlapping posts (70 mm= 20 + 50))
30#= Dimension in door closed position
Max opening is affected by "A" mm with lock (without door accessories*)

Item No.	Art No.	Qty.	
		090	140
X	322-XXXXXX	1	1
Y	322-XXXXXX	1	1
Z	P11-XXX	3	3

Locks	A (lock to post)
L20-05-0 (Snap lock)	-
L20-05-2 (Hitch lock)	105 mm
XIT-L/R01-301 (Cylinder lock)	-
XIT-L/R14-301 (Slam shut)	215 mm
XIT-L/R09-301 (Electric)	-
L66-20/21-L/R (X-lock)	190 mm
B-135 (MGB)	-
B-136 (MGB Escape Release)	135 mm